

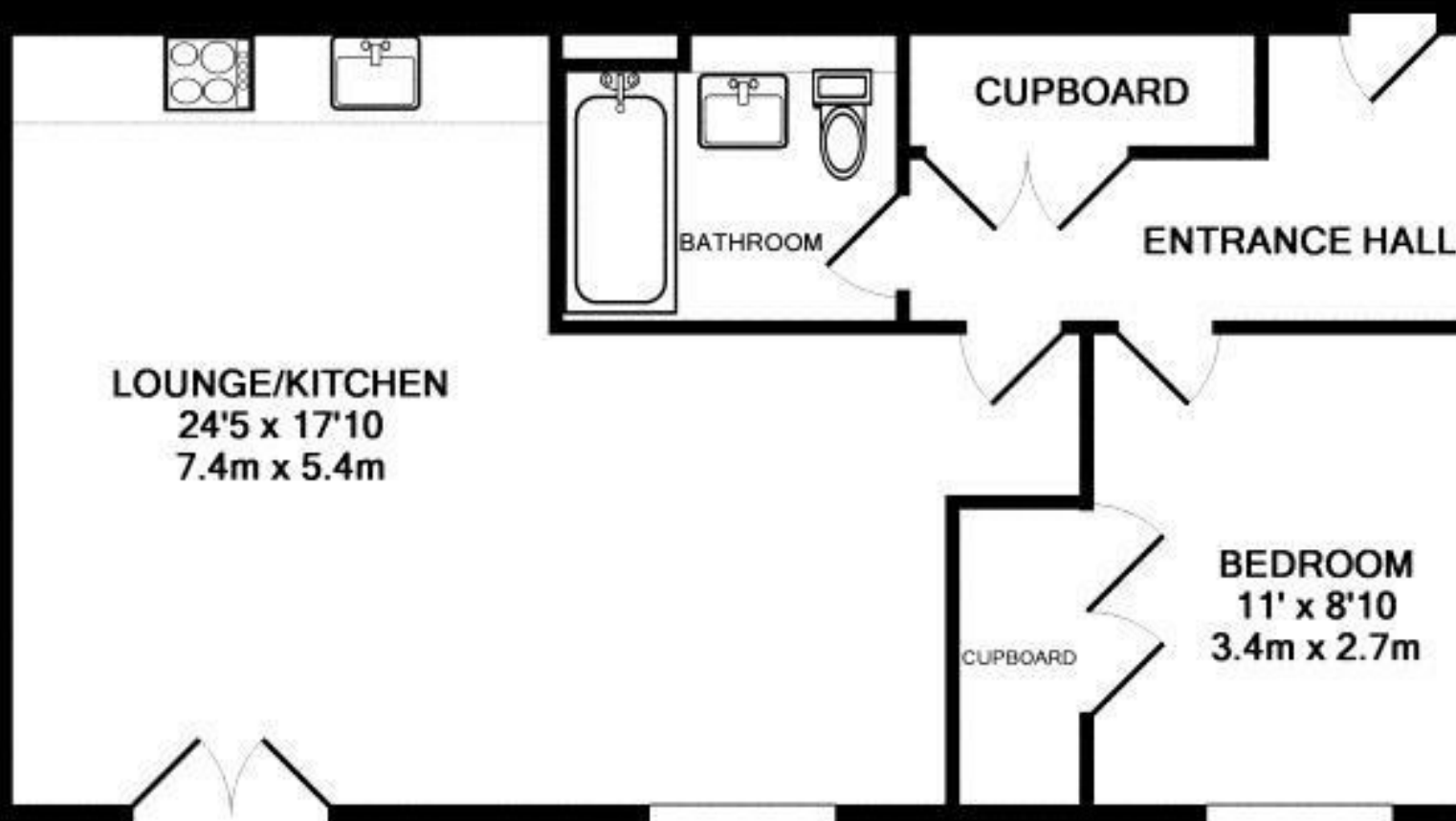

Maidstone Road | Norwich | NR1
 PCM £800 PCM

abbotFox

| Energy Efficiency Rating | | |
|---|---------|-------------------------|
| | Current | Potential |
| Very energy efficient - lower running costs | | |
| (92 plus) A | | |
| (81-91) B | | |
| (69-80) C | | |
| (55-68) D | | |
| (39-54) E | | |
| (21-38) F | | |
| (1-20) G | | |
| Not energy efficient - higher running costs | | |
| England & Wales | | EU Directive 2002/91/EC |



TOTAL APPROX. FLOOR AREA 55.0 SQ.M. (592 SQ.FT.)

Whilst every attempt has been made to ensure the accuracy of the floor plan contained here, measurements of doors, windows, rooms and any other items are approximate and no responsibility is taken for any error, omission, or mis-statement. This plan is for illustrative purposes only and should be used as such by any prospective purchaser. The services, systems and appliances shown have not been tested and no guarantee as to their operability or efficiency can be given

Made with Metropix ©2007

Disclaimer – In accordance with the Property Misdescriptions Act, the company gives notice that all descriptions, references to condition, necessary emissions for use and other details are given in good faith and believed to be correct, but any intending purchasers do not rely on them as statements of fact, but must satisfy themselves by inspection or other means, as to their accuracy.

*****UNDERGROUND PARKING***** abbotFox presents this property in the heart of the City Centre, this second floor apartment offers open plan living, one double bedroom, secure entry system, private garden and underground parking. Set in the much sought after Maidstone Road development within walking distance of the city centre with its wide range of high street shops, shopping malls, pubs, popular restaurants and the historical Norman castle and cathedral.

